

CONFIDENTIAL

VERTRAULICH

THIS DRAWING IS THE EXCLUSIVE PROPERTY OF MARQUARDT. WITHOUT THEIR CONSENT IT MAY NOT BE REPRODUCED OR GIVEN TO THIRD PARTIES.

A	recommended cut-out for snap-in fixing (edge opposite to snap-in direction)	1	2	3	4
			wall thickness	length of cut-out	width of cut-out
			0.75 to 1.25	19.2 -0.1	12.9+0.1
			1.25 to 2	19.4 -0.1	12.9+0.1
		2 to 3	19.8 -0.1	12.9+0.1	

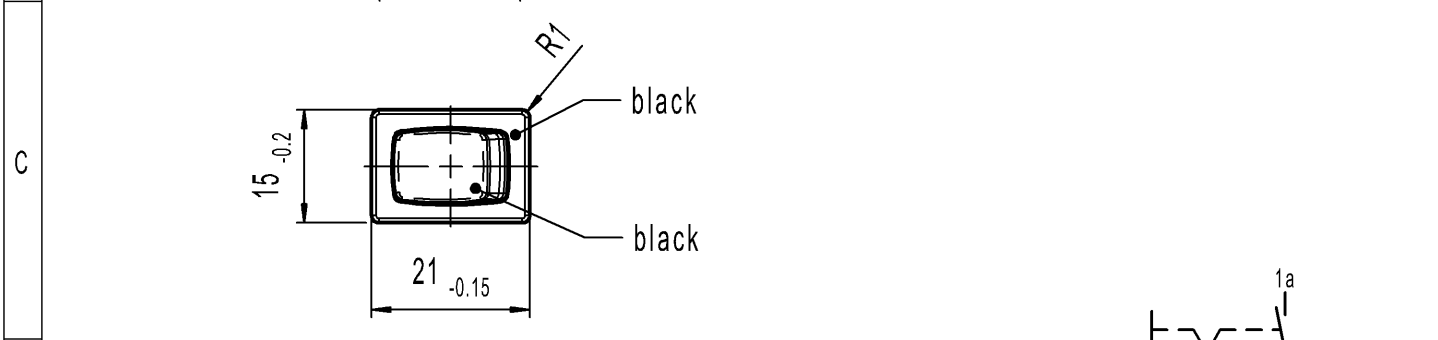
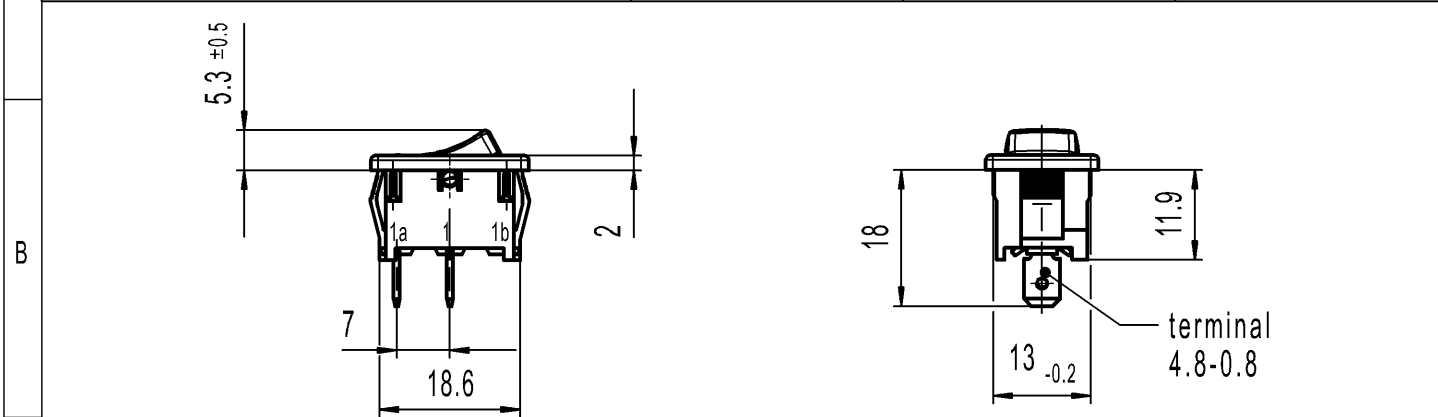

Marking

18..

 6(4)/250~5E4 T100/55

 10(4)/250~

 5/50A 250V~

SPST
Suitable for appliances of class II

6A 125-250V AC
 1/4 HP 125V AC
 1/2 HP 250V AC
 R 30

Code of manufacture: place/year/week

On Box: Customer Part No. see variant table

-		-		132 576-00	1801.1102-XX
Figure		Type		Customer Part No.	Art.No.-PI
Shape and location	Angle ± 2°	Length		Sheet 01	Ident. K
	Edge tolerance	0-6 ± 0.2	±	± 0.2	Document number 18011102
		>6-15 ± 0.4	±	±	Index h
		>15-30 ± 0.4	±	±	
		>30-70 ±	±	±	
		>70-120 ±	±	±	
		>120-200 ±	±	±	
		±	±	±	
h	137838	2021-05-28	JOSHIO		Appliance Switch
g	43724	2005-07-19	vor		
f	25489	1997-10-28	GRH		
e	25088	1997-06-24	SIG		
Index	MEC-No.	Date (YYYY-MM-DD)	Edited by		
				Format DIN A4	Projection
				Scale 1:1	
				All dimensions are in millimetres	
				System NX V1872	
				Replacement of	
				Zg.gl.Nr.v.24.06.1997	

Alle Rechte bei Marquardt, auch fuer den Fall von Schutzrechtsanmeldungen. Jede Verfuugungsbezugnis, wie Kopier- und Weitergaberecht, bei uns.

©