

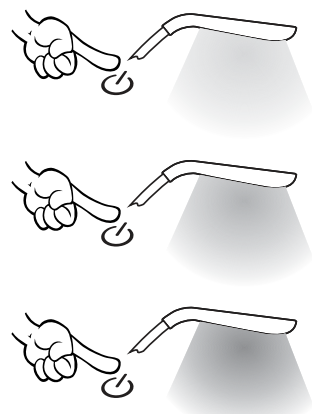

FL-11

FYSIC®

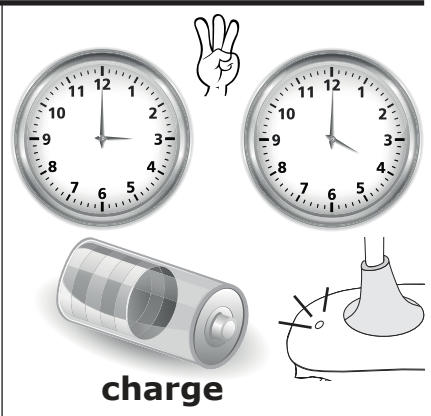
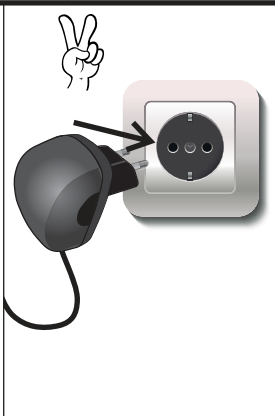
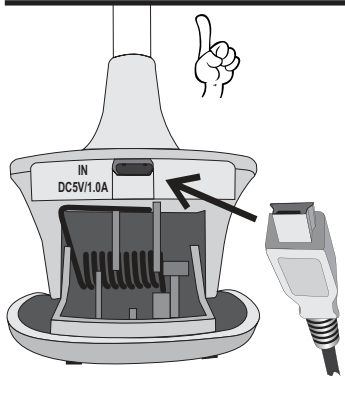
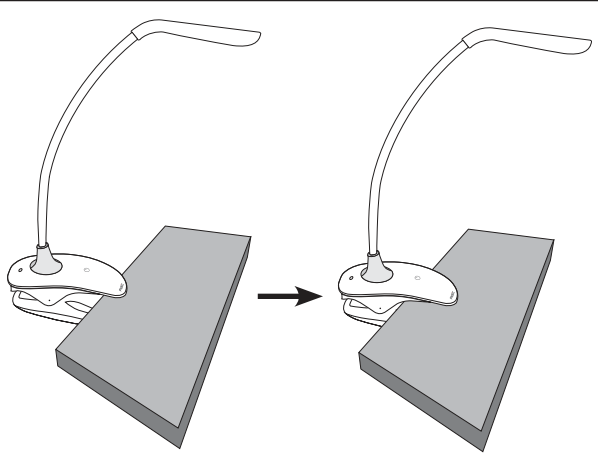
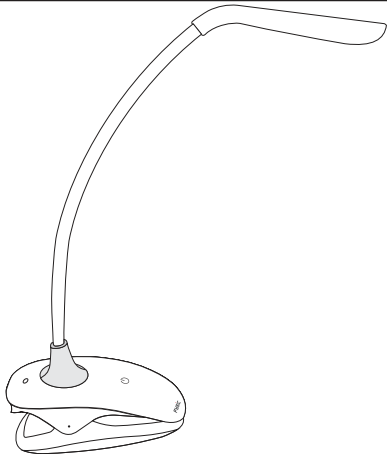

Specification:

DC supply voltage: DC5V / 1A
Working environment: -5~40°C
LED type lamp: 6000-6500K, 0.2W
LED quantity: 6 pcs
LED life: ≥30000 hours
High brightness 100LM / ±390mA
Mid brightness 35LM / ±140mA
Low brightness 8LM / ±38mA
Battery: Li-Po 3.7V 600mAh
Adapter: excl.